

Part Number : 50004

INSTRUCTIONS SLIP-ON CAM COVER

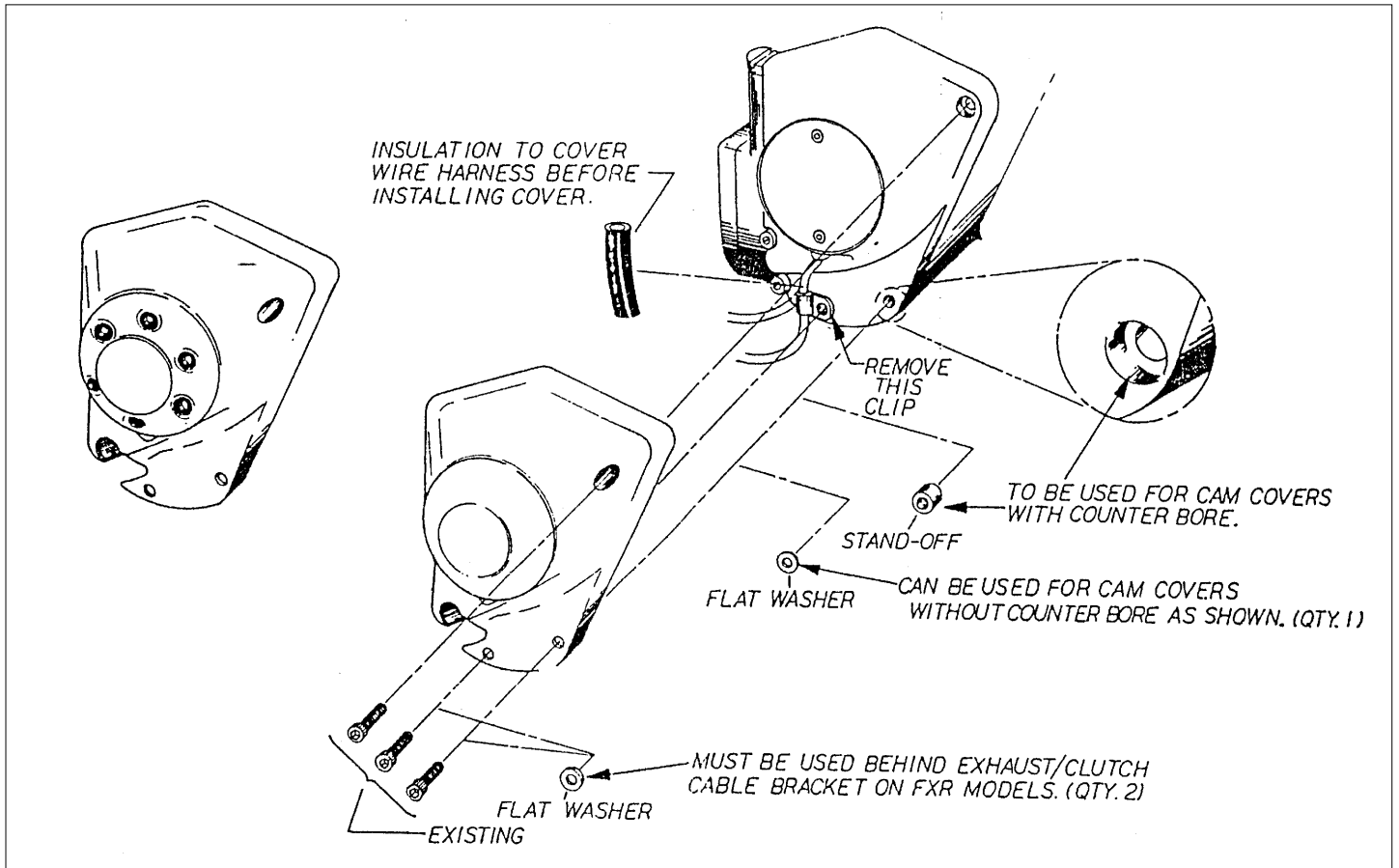

These covers are designed to fit over the existing cam covers on 1970 to present Big Twin models. Due to variances in OEM cam cover castings from year to year, the supplied spacer and washers will be needed to ensure the best possible fit and spacing.

NOTES:

1. FXR models with exhaust/clutch cable brackets mounted to the bottom of the cam cover will require flat washers to be placed behind the bracket before reinstalling it.
2. Models equipped with mid-mount brakes will require removal of the brake pedal. Consult appropriate OEM service manuals for proper method of removal and installation.
3. Some models will require that the front exhaust pipe be removed during installation of these covers.
4. Late 1987 to the present FXST models will require that the rear master cylinder be loosened slightly from support bracket and rotated outward to allow cover to slip past brake fluid hose to remote reservoir. Consult appropriate OEM service manual for proper Information concerning brake removal and installation.
5. Some models will require the removal of the wire clip which holds the ignition wire to the cam cover. Carefully install rubber wire protector over ignition wire before installing cover. This is to protect wire as it exits from the cover.